

DIMMER



The **Fluence Dimmer** is a reliable, user-friendly dimmer that controls the light intensity from 0-100% of Fluence light fixtures. This device allows growers to control the light intensity of their Fluence light fixtures via an easy-to-use up/down arrow function, and clearly shows the user their light output intensity percentage via a digital display. This dimmer is meant to control the overall light intensity and maintain a set point of your Fluence LED light fixtures. It is not a relay or digital schedule timer to control photoperiod.

0-10V/PWM
MODE BUTTON

DIMMING SIGNAL OUT-
PUT PORT

12V DC INPUT
POWER PORT

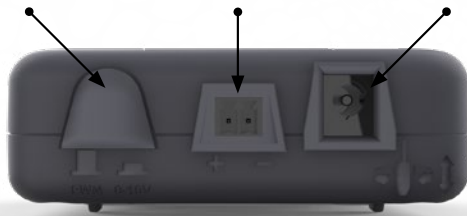

INCLUDED IN THE BOX



AC Power Adapter

U.S. Plug AC Power Adapter provides 12VDC power for the Whisper dimmer. 120V wall outlet or power strip required.



Signal Wire Connectors

Two 2-position terminal connectors are included to connect the dimming signal wires. Use one and keep the second as a spare.

DIMENSIONS

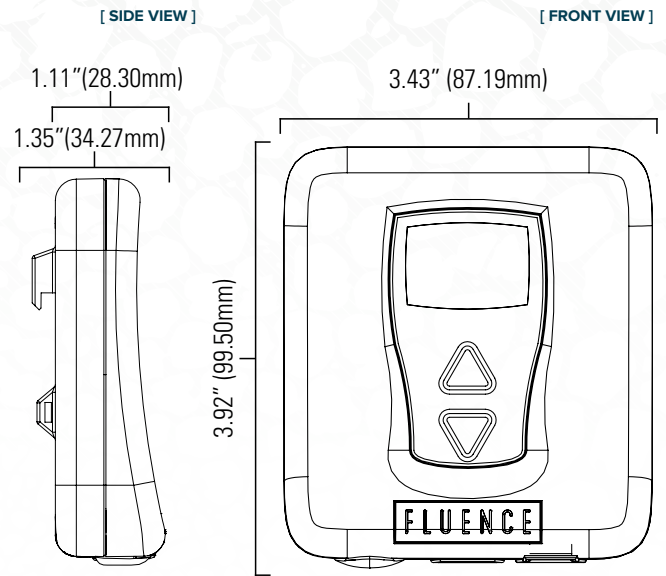

SPECIFICATIONS

Number of Channels	1
Signal Type	0-10V or PWM
Signal Strength	Source/Sink 40 mA DC
Max # of Fixtures Controlled	25 units, or 80% max loading (32 mA) recommended
Max Signal Wire Length	200 feet max 61 meters max
10V Output Control	0-10V \pm 0.1V
PWM Output Control	0-100% \pm 1%
Adapter AC Input Power	120VAC 60 Hz
Dimmer DC Input Power	+12 VDC at 0.5A, sourced Wall Power
Dimensions Weight	3.92" L x 3.43" W x 1.35" H 5 oz 99.50mm L x 87.19mm W x 34.27mm H 142 g
Warranty	1-year
Light Control	0%-100% Light Intensity
Relative Humidity	Less than 80%+
User Interface	Two Push Buttons

Please refer to the user manual for complete operation and application information.



Contact **FLUENCE**

support@fluence.science

www.fluence.science

ORDERING CODE LEGEND

DESCRIPTION	Product	Current	Region	-	Part NO.	-	Packing QTY.
	A - Accessory C - Cable	DM - DC Dimming	G - Global A - Americas E - Europe	-	Part NO.	-	10 05
EXAMPLE	ADMA			-	70893	-	10



DIMMER AND ACCESSORIES - ORDERING INFORMATION

Ordering Code	Description	Cable Length	Connector End 1	Connector End 2	Cord Type
C-W-U	Dimmer Includes 2 Signal Wire Connectors and AC/DC Power Adapter	N/A	N/A	N/A	N/A
ADMA-70983-10	Signal Wire Connector 2-position Terminal Block	N/A	N/A	N/A	N/A
ADMA-10342-10	AC/DC power adapter 120VAC/12VDC, 12W, 1A	3.3 ft 1000 mm	NEMA 1-15P	2.0 mm Locking Barrel	UL2468
CDMA-71388-10	DC Dimming Signal Cable Dimmer to Power Supply	5.0 ft 1524 mm	Pushlock Female M16, 3-pin	Pigtail	UL 22190 2x18AWG+Drain Mylar Jacket VW-1
CDMA-70972-10	DC Dimming Signal Cable Dimmer to Power Supply	10.0 in 254 mm	Pushlock Female M16, 3-pin	Pigtail	UL 2464 2x22AWG Extruded Jacket, VW-1
CDMA-70441-10	DC Dimming Signal Cable Dimmer to Power Supply	10.0 in 254 mm	Threaded Female M16, 3-pin	Pigtail	UL 2464 2x22AWG Extruded Jacket VW-1
CDMA-71370-10	Connector Adapter Pushlock to Threaded	6.7 in 170 mm	Threaded Female M16, 3-pin	Pushlock Male M16, 3-pin	AW, UL 22190 2x18AWG, Drain Mylar, VW-1, CE

DIMMER AND ACCESSORIES - PACKAGING INFORMATION

Ordering Code	Package Qty	Weight	Length	Height	Width	HTS Tariff Code
C-W-U	1	1.0 lbs 0.46 Kg	8.0" 203 mm	3.5" 89 mm	7.0" 178 mm	8537.10.9160
ADMA-70983-10	10	0.5 lbs 0.23 Kg	7.3" 185 mm	N/A	12.0" 305 mm	8536.69.4040
ADMA-10342-10		2.0 lbs 0.9 Kg	7.3" 185 mm	N/A	12.0" 305 mm	8504.40.9510
CDMA-71388-10		4.7 lbs 2.1 Kg	15.5" 394 mm	5.0" 127 mm	15.5" 394 mm	8536.69.8000
CDMA-70972-10		2.0 lbs 0.9 Kg				
CDMA-70441-10		2.0 lbs 0.9 Kg				
CDMA-71370-10		2.3 lbs 1.1 Kg				

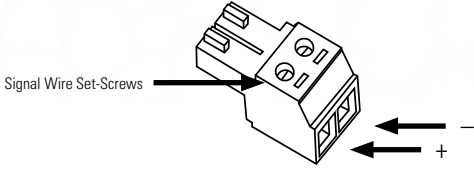
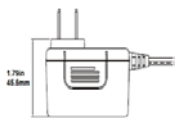
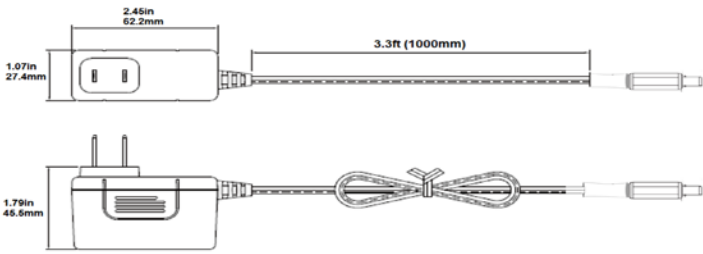
DIMMER AND ACCESSORIES - MECHANICAL DRAWINGS

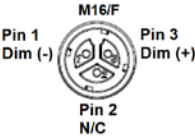
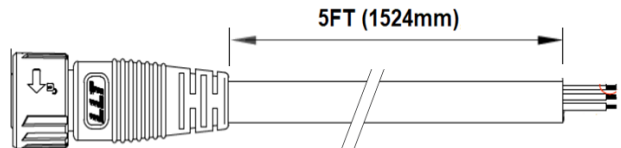
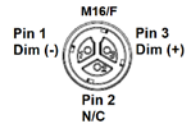
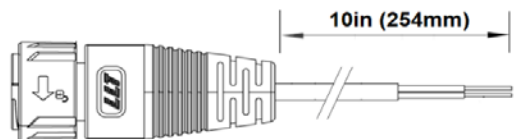
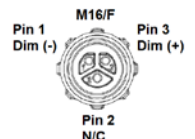
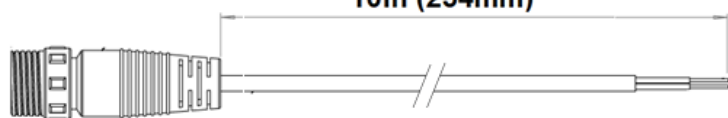
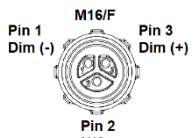
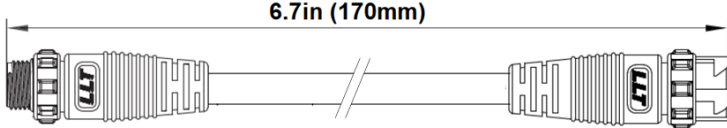
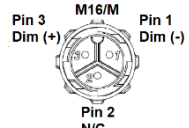
Ordering Code	Pin Config. End 1	Mechanical Drawing	Pin Config. End 2
ADMA-70983-10	N/A		N/A
ADMA-10342-10			
CDMA-71388-10			Red = Dim (+) Black = Dim (-) Bare Wire = Drain
CDMA-70972-10			Purple = Dim (+) Gray = Dim (-)
CDMA-70441-10			Purple = Dim (+) Gray = Dim (-)
CDMA-71370-10			

Dimmer with Single Light Fixture
Fluence DC Dimming Cable

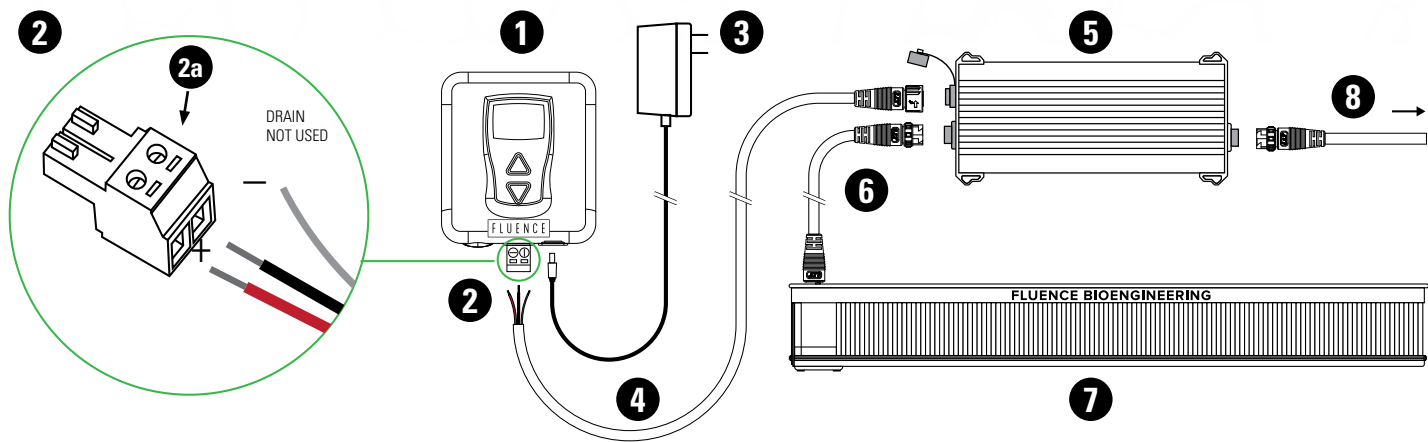

COMPONENTS

- 1 Dimmer C-W-U
- 2 Dimming Signal Wire Connector (ADMA-70983-10)
 - 2a Signal Wire Set-Screws
- 3 120 VAC Power Adapter (ADMA-10342-10)
- 4 DC Dimming Signal Cable (CDMA-71388-10)
- 5 Power Supply for Light Fixture
- 6 DC Power Cable to Light Fixture
- 7 Light Fixture
- 8 AC Power Cable to Power Supply

SINGLE LIGHT FIXTURE

Maximum Quantity Connected Light Fixtures	Maximum Distance Dimmer to Light Fixture
1	5 FT 1.5 m

NOTES

Dimming threaded cable adapter (CDMA-71370-10) or threaded Dimming Signal Cable (CDMA-70441-10) is required for RAZR, RAY, SPYDRx, and SPYDRx PLUS.

Dimmer with Multiple Light Fixtures

Fluence DC FLeX Dimming Wiring System

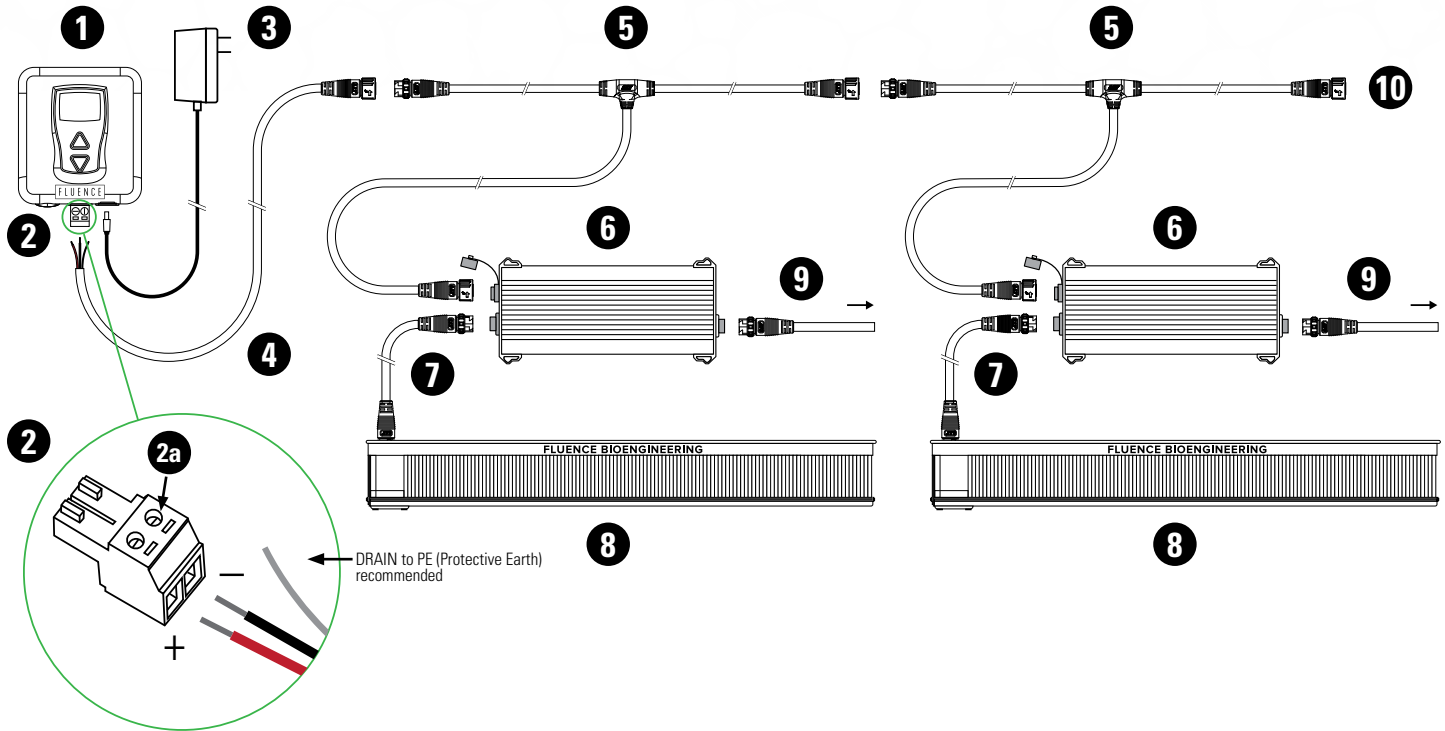

COMPONENTS

- 1 Dimmer C-W-U
- 2 Dimming Signal Wire Connector (ADMA-70983-10)
 - 2a Signal Wire Set-Screws
- 3 120 VAC Power Adapter (ADMA-10342-10)
- 4 DC Flex Pigtail Trunk Extension Cable
 - 5 FT (CDMA-71389-10) or
 - 75 FT (CDMA-71366-01)
- 5 DC Flex T-Connector Cable to Light Fixture
 - 5 FT (CDMA-71369-10) or
 - 10 FT (CDMA-71368-05)
- 6 Power Supply to Light Fixture
- 7 DC Power Cable to Light Fixture
- 8 Light Fixture
- 9 AC Power Cable to Power Supply
- 10 DC Flex T-Connector Cable to next Light Fixture
 - 5 FT (CDMA-71369-10) or
 - 10 FT (CDMA-71368-05) or
 - terminate with Dust Cap (CDMA-71375-10)

MULTIPLE LIGHT FIXTURES

Maximum Quantity Connected Light Fixtures	Maximum Distance First to Last Light Fixture
25	200 FT 61m

NOTES

A. Threaded Connector Adapter (CDMA-71370-10) is required for RAZR, RAY, SPYDRx, and SPYDRx PLUS.

B. Please refer to the **DC Flex Dimming Wiring System Specification Sheet** for wiring details.

Dimmer with Third Party Dimming Cables

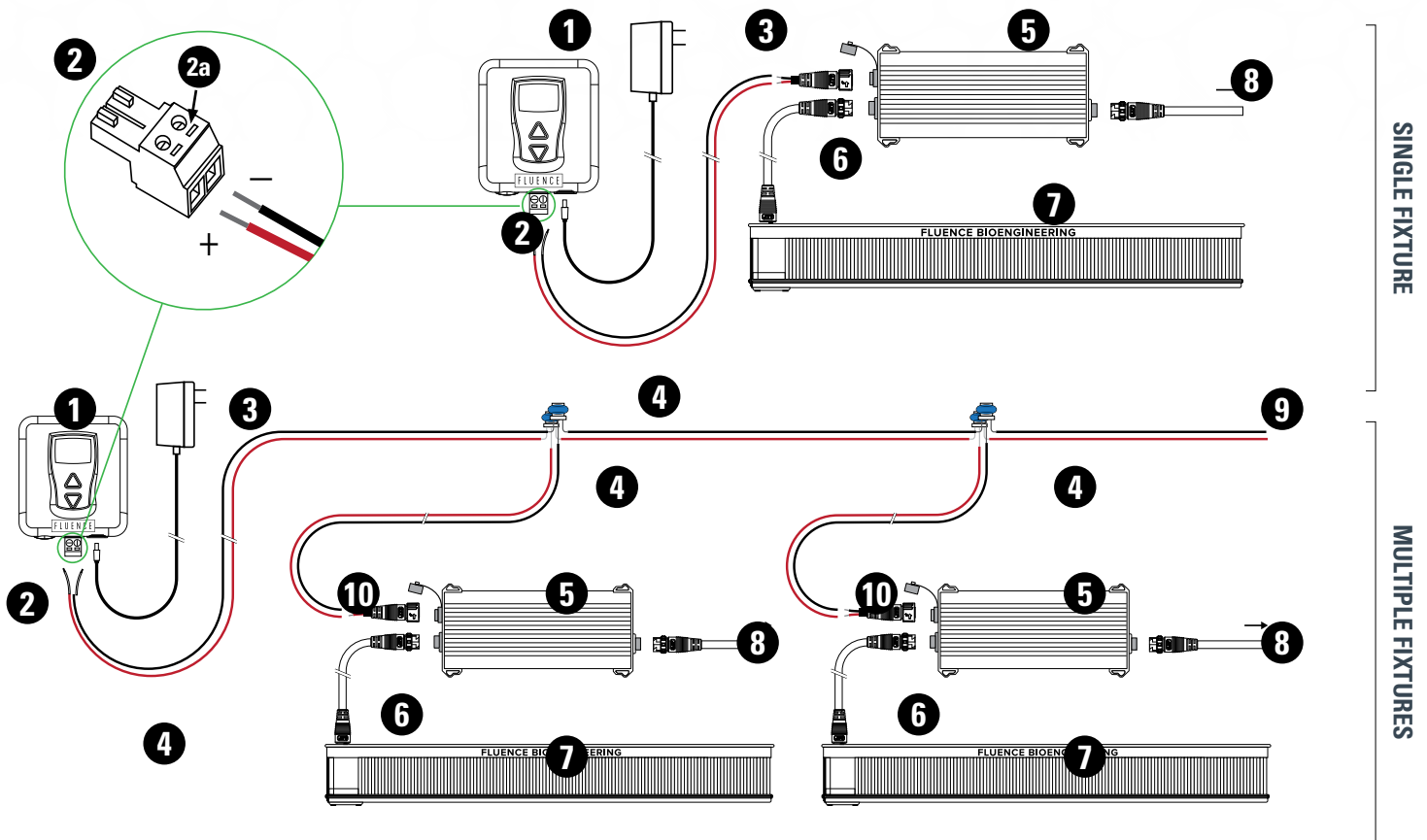

COMPONENTS

- 1 Dimmer C-W-U
- 2 Dimming Signal Wire Connector (ADMA-70983-10)
 - 2a Signal Wire Set-Screws
- 3 120 VAC Power Adapter (ADMA-10342-10)
- 4 2-Conductor Dimming Cable and Wire Splice Connectors (third party)
- 5 Power Supply for Light Fixture
- 6 DC Power Cable to Light Fixture
- 7 Light Fixture
- 8 AC Power Cable to Power Supply
- 9 Dimming cable to next Light Fixture or terminate
- 10 DC Dimming Signal Cable
 - Pushlock connector (CDMA-70972-10) or
 - Threaded connector (CDMA-70441-10)

Min. Wire Gauge	18 AWG 0.75 mm ²
Conductor QTY.	2
Recommended Cable	Belden, PN: 5340F1
Recommended Wire Splice Connector	3M PN: 314 Scotchlok IDC Connectors 22-14 AWG
Max QTY. Connected Light Fixtures	25
Max Distance First to Last Light Fixture	200 FT 61 m

NOTES

Maintain the polarity at all dimming connections, (+) wire to (+) wire and (-) wire to (-) wire.