

Dimmer with Single Light Fixture

Fluence DC Dimming Cable

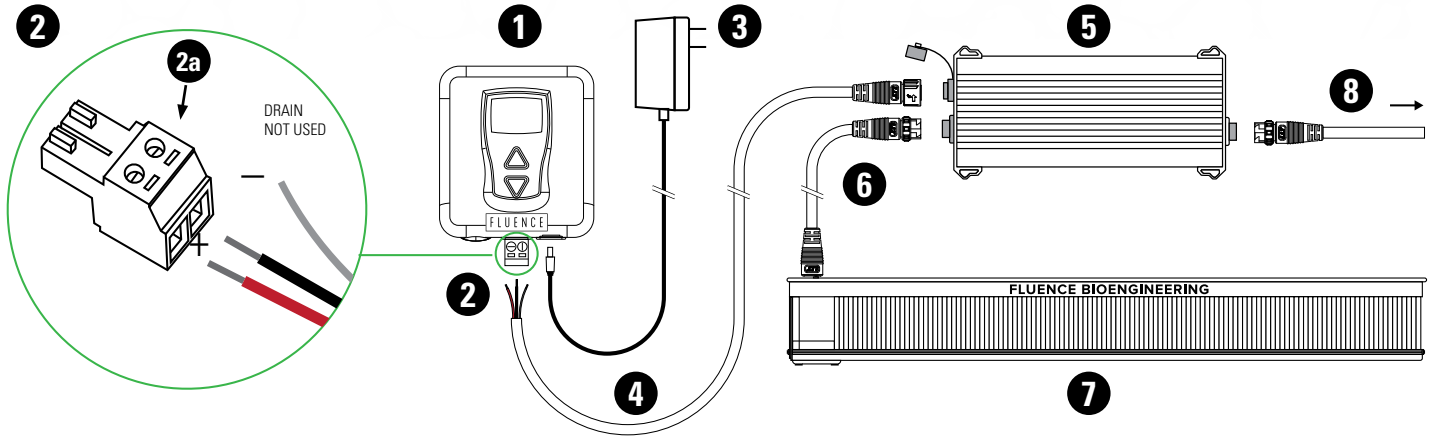

COMPONENTS

- 1 Dimmer C-W-U
- 2 Dimming Signal Wire Connector (ADMA-70983-10)
 - 2a Signal Wire Set-Screws
- 3 120 VAC Power Adapter (ADMA-10342-10)
- 4 DC Dimming Signal Cable (CDMA-71388-10)
- 5 Power Supply for Light Fixture
- 6 DC Power Cable to Light Fixture
- 7 Light Fixture
- 8 AC Power Cable to Power Supply

SINGLE LIGHT FIXTURE

Maximum Quantity Connected Light Fixtures	Maximum Distance Dimmer to Light Fixture
1	5 FT 1.5 m

NOTES

Dimming threaded cable adapter (CDMA-71370-10) or threaded Dimming Signal Cable (CDMA-70441-10) is required for RAZR, RAY, SPYDRx, and SPYDRx PLUS.